

ooni

Ooni 3

MANUAL & SAFETY INSTRUCTIONS

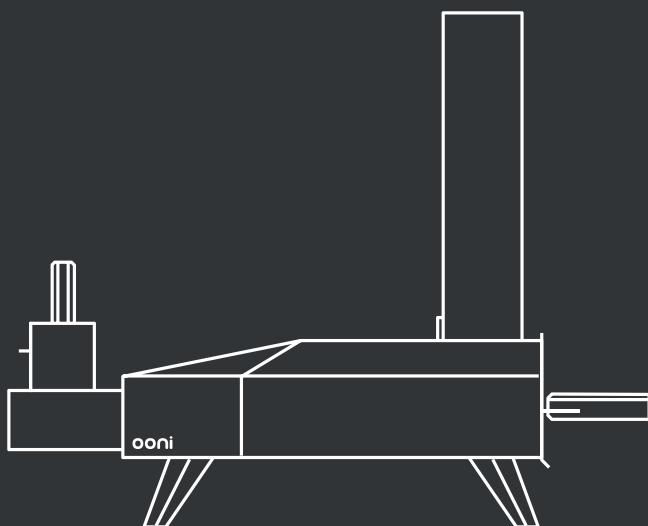



Safety legal disclaimers	2	Translations	
		CH	34
What's in the box	14	DA	35
		DE	36
Product diagram	16	ES	37
		FI	38
Assembly	17	FR	39
		IT	40
Lighting	30	IW	41
		JP	42
Extinguishing	33	NL	44
		SV	45



WARNING:

This barbecue will become very hot. Do not move it during operation.

Do not use indoors.

Do not use spirit or petrol for lighting or re-lighting. Use only firelighters complying to EN 1860-3.

Keep children and pets away.

Safety Legal Disclaimer – Must be read in full prior to use

Please read the present legal disclaimer fully before assembling, installing and using/servicing your Ooni. Failure to comply with all the provisions of the present legal disclaimer could result in property damage, serious bodily injury or even death, or in a fire causing damage to property.

1. Ooni is designed for outdoor use only. Ooni must always be placed outdoors, away from structures and never inside a building or a garage or in proximity to any enclosed area. Place your Ooni on a sturdy, level, stable and non-flammable surface and keep it clear and free from flammable or combustible materials, gasoline and other flammable vapours and liquids.
2. Be aware of any local laws or regulations that may specify a required distance between outdoor cookers and any structures, or that may limit outdoor flame of any type during drought or fire hazard periods.
3. Do not install or use your Ooni in or on boats or recreational vehicles.
4. Do not use your Ooni in high winds.
5. Your Ooni is not intended to, and should never be used as a heater.
6. Toxic fumes can accumulate and may cause asphyxiation.
7. Flames can blow outside of the metal enclosure:
 - a. at the back where the fire is;
 - b. from the top of the hopper when the lid is opened;
 - c. from the front of the oven when you open the door; or
 - d. from the top of the chimney.
8. Please keep away from the Ooni's openings and warn others around you.
9. Improper installation, adjustment, alteration, service or maintenance of your Ooni may cause injury or property damage. Therefore, do not use your Ooni unless it is completely assembled and all parts are securely fastened and tightened.
10. Your Ooni should be inspected on a regular basis.
11. The length of pellets used can greatly affect the temperature of your Ooni. The recommended pellet length should be no longer than 1.25" (3cm). Longer pellets have a slower feed rate which can cause your Ooni to burn colder. When changing or refilling pellets be aware of the average length and adjust your Ooni setting accordingly.
12. Only use pellets intended for use in cooking.
13. When using your Ooni, there is a risk for your hands to be burned. This is why you should at all times use protective heat resistant gloves to avoid burns and you should never set hot items on or near combustible surfaces. DO NOT touch any metal parts when your Ooni is operating. Only touch the wooden handles to open the door and lift the hopper lid.
14. Never leave your Ooni unattended. Do not leave your Ooni unattended with the lid open while lit. Be aware of fire hazards (dry leaves, decking and other combustible materials) that may be in proximity to the Ooni while it is in use as they may present a fire hazard if any sparks are allowed to come into contact.
15. Keep all electrical cords away from your Ooni.
16. Ooni is to be used by responsible adults only.
17. Keep children, pets, and combustible items away from your Ooni at all times.
18. Do not attempt to move your Ooni when it is hot or while cooking.
19. DO NOT leave any hazardous objects such as lighters or barbecue lighting fluid next to your Ooni. Indeed, Ooni radiates heat to all directions.
20. Ooni remains hot even after visible flames have died down. Allow a minimum of 60 minutes for it to cool down once you are done using it. DO NOT cover the Ooni immediately after it has been used and make sure all the fire and glowing embers have disappeared from the burner before storing it.
21. The approximate temperature of your Ooni (when being used) ranges from 250°F (120 °C) to 1000°F (550 °C).
22. Ooni is safe and hazard free when used as intended and according to safety guidelines, and will provide years of trouble-free use and enjoyment. It is the users' responsibility to maintain safe operation of the Ooni and to exercise reasonable standards of care at all times.

OONI LIMITED DOES NOT ACCEPT ANY RESPONSIBILITY, LEGAL OR OTHERWISE, FOR THE INCIDENTAL OR CONSEQUENTIAL DAMAGE TO PROPERTY OR PERSONS RESULTING FROM THE USE OF OONI WHICH DOES/DID NOT COMPLY WITH ANY OF THE PROVISIONS OF THE PRESENT LEGAL DISCLAIMER.

OONI LIMITED SHALL IN NO EVENT BE LIABLE FOR ANY SPECIAL, INDIRECT, CONSEQUENTIAL OR OTHER DAMAGES OF ANY NATURE WHATSOEVER IN EXCESS OF THE ORIGINAL PURCHASE PRICE OF OONI.

What's in the box

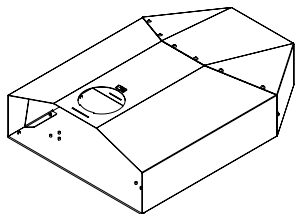

1
Main body

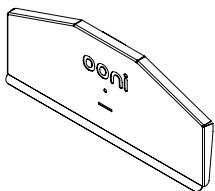

2
Door



3
L-bracket

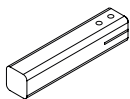

4
Door handle



5
Chimney

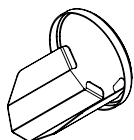

6
Scoop/cap

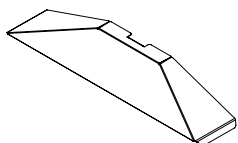

7
Flame keeper

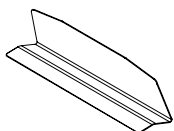

8
Flame guard

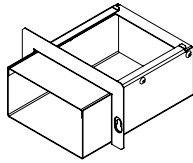

9
Burner body

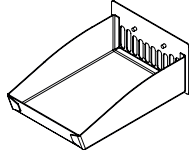

10
Burner tray

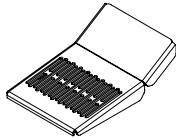

11
Burner grate

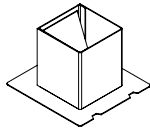

12
Hopper



13
Hopper lid

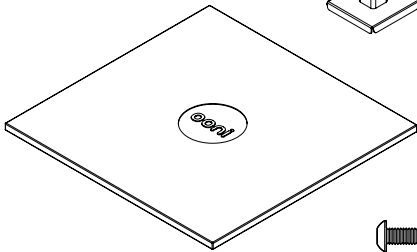

14
Stone baking board



15
M5-10mm (x3)



16
M5-20mm (x1)



17
M5-25mm (x3)



18
5mm Allen Key

Product diagram

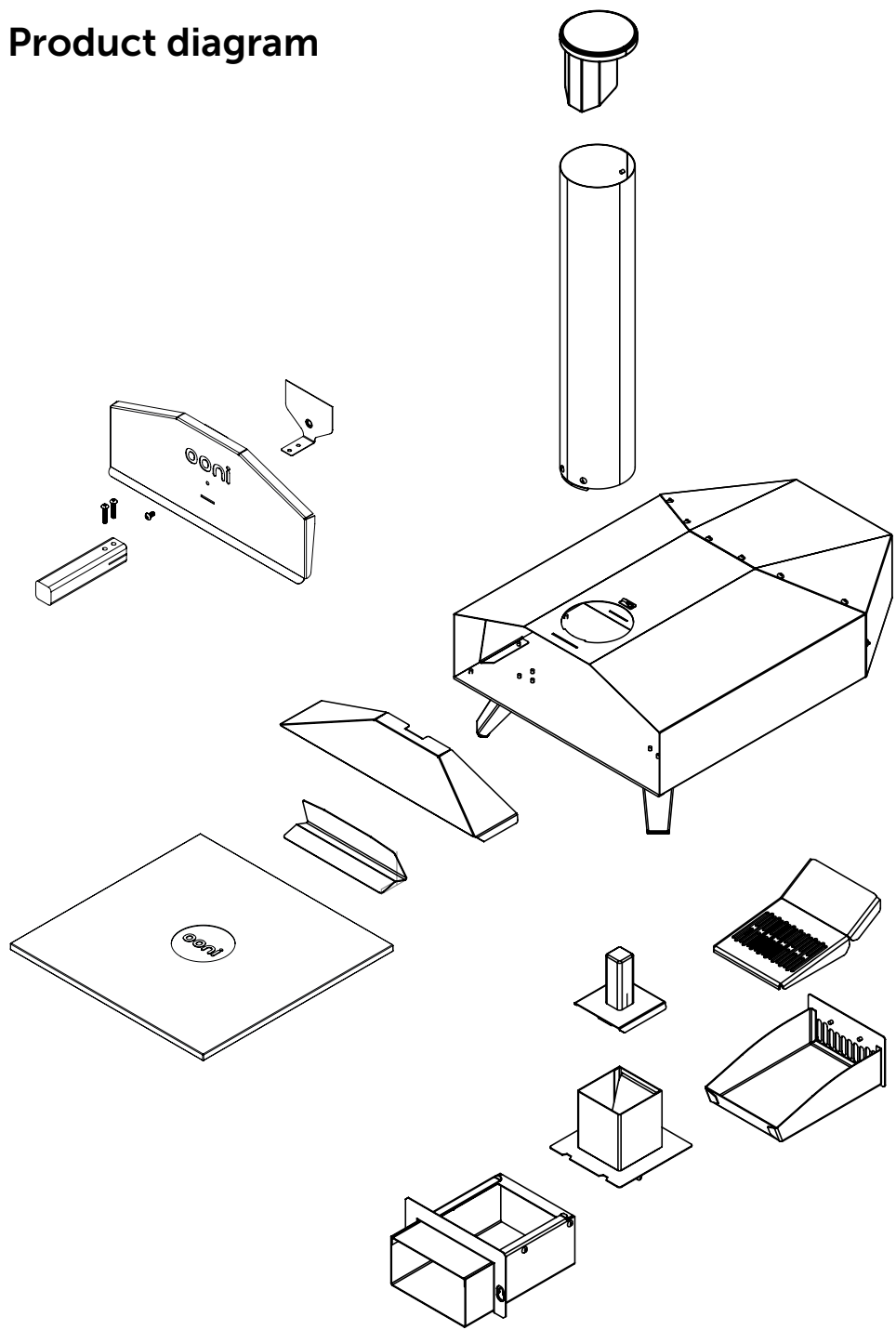

Assembly instructions

1. Unfold the legs.

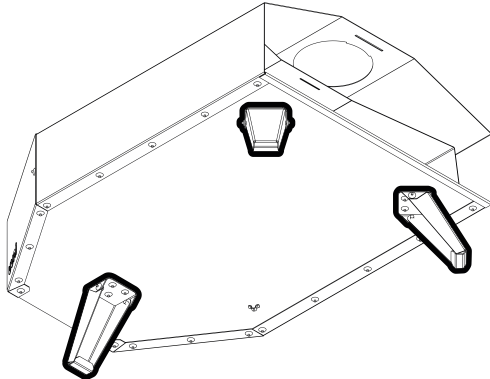
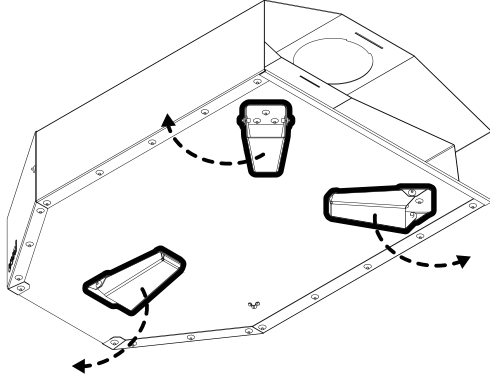

2a. Attach the burner body to the main body.

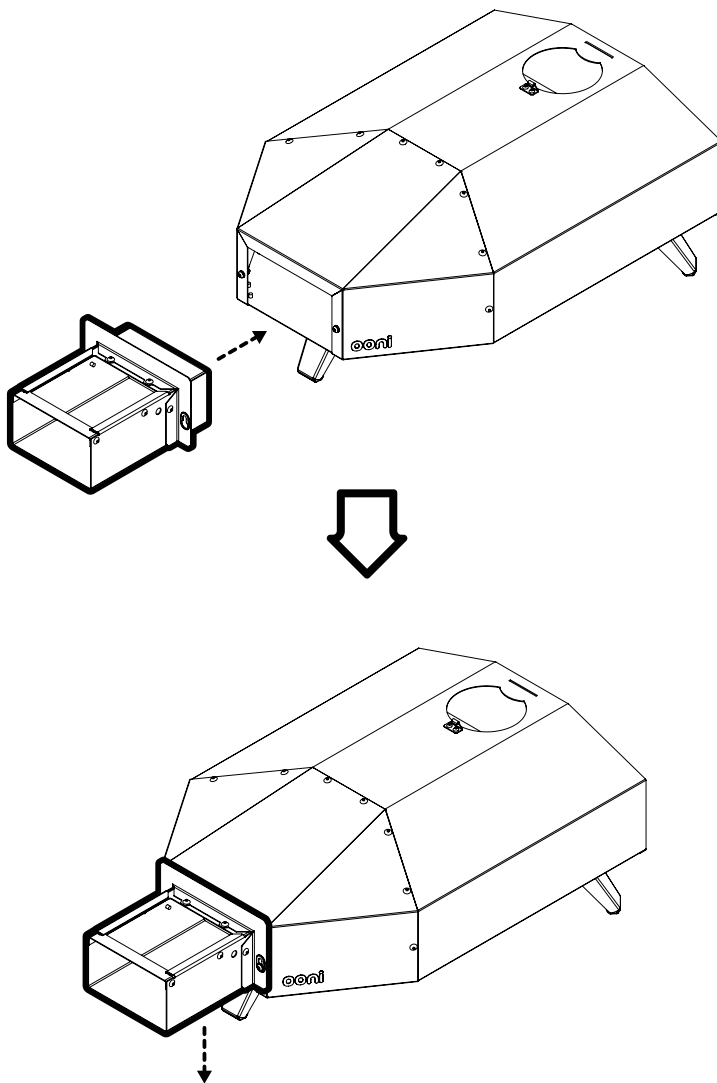

2b. Secure the burner body using your Allen Key.

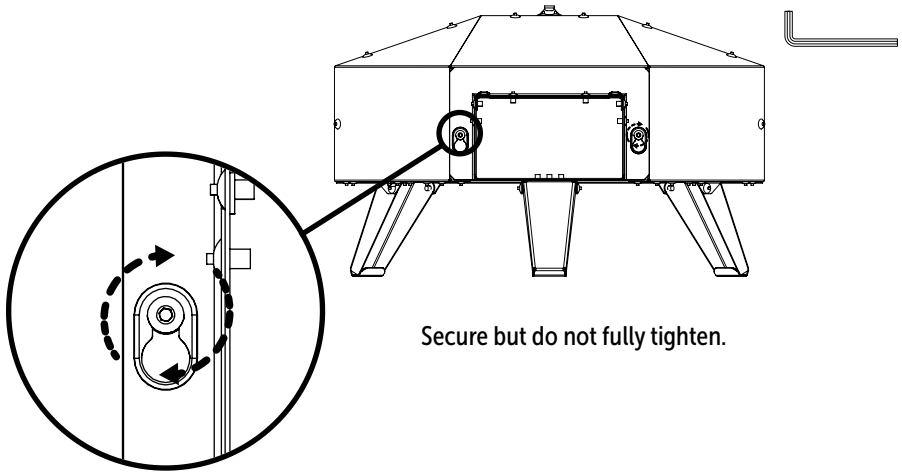

2c. Slide the hopper into the burner body.

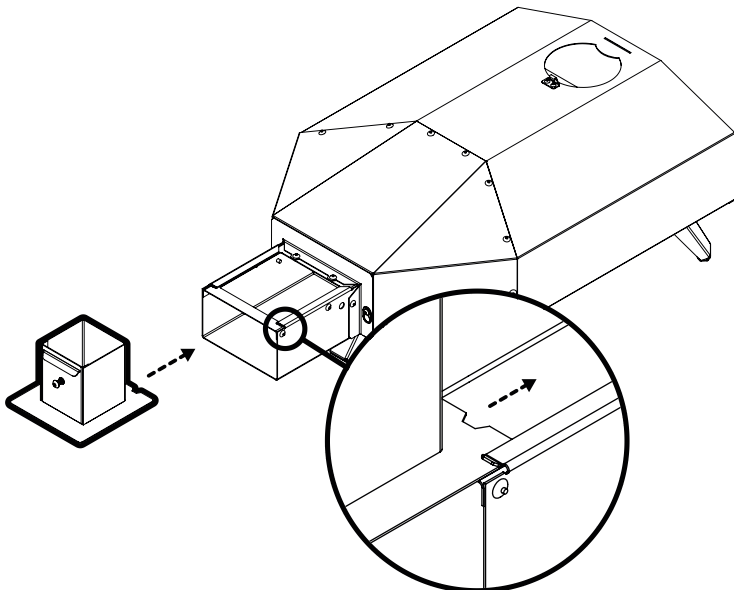

2d. Insert the burner grate into the burner tray.

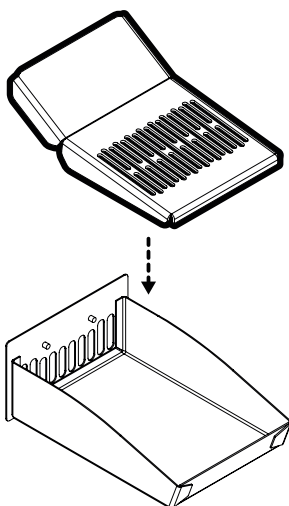

2e. Slide the burner grate and burner tray in to the burner body.

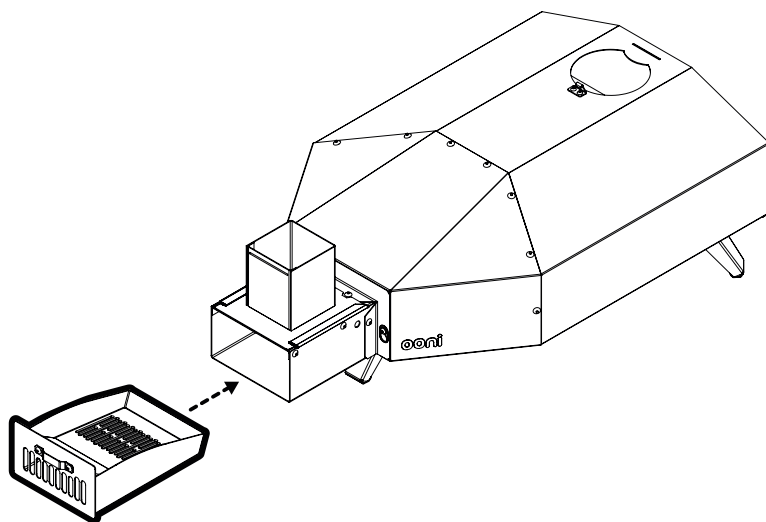

2f. Add the hopper lid to the hopper.

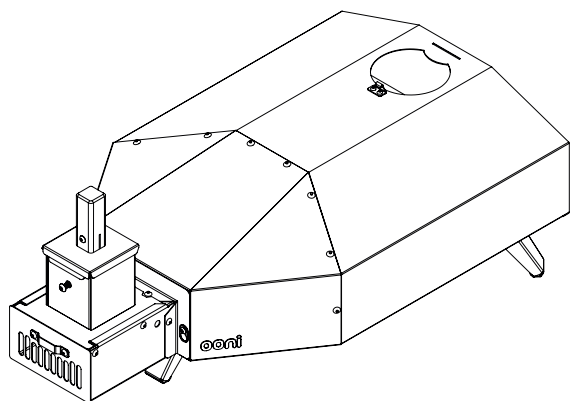
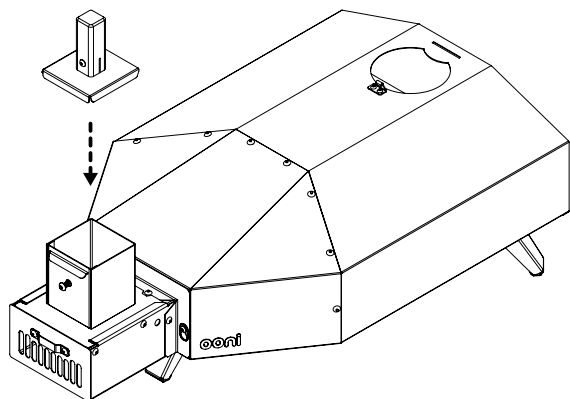

3a. Place the flame keeper inside the main body.

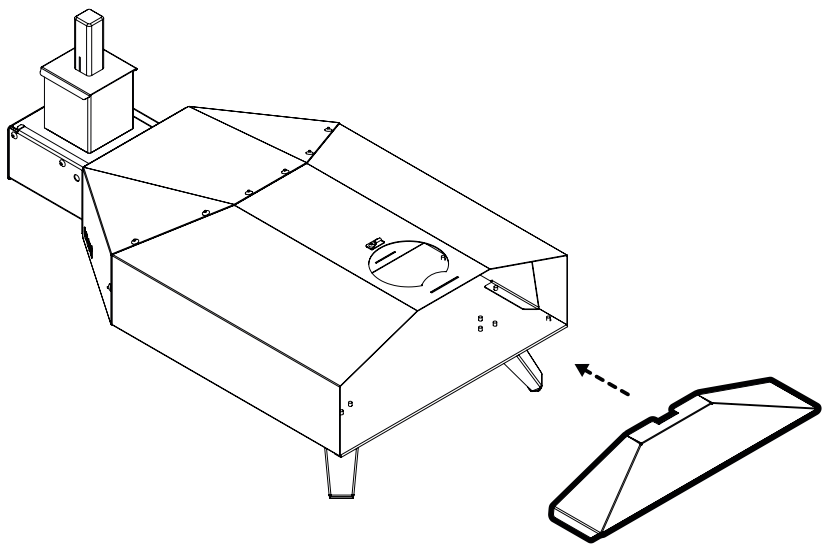

3b. Secure the flame keeper using the slot inside the main body.

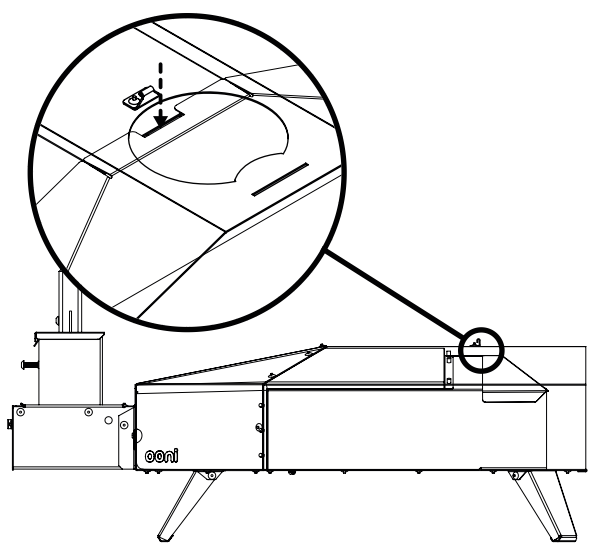

4a. Align the chimney slot with the tab on the main body.

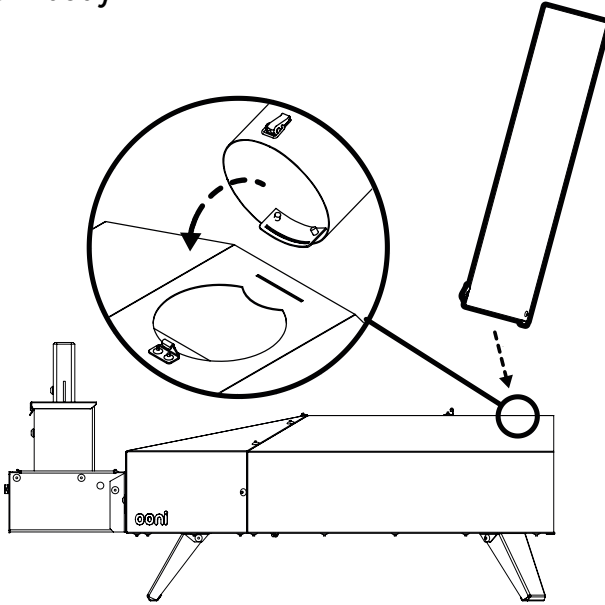

4b. Secure the chimney to the main body using the chimney clip.

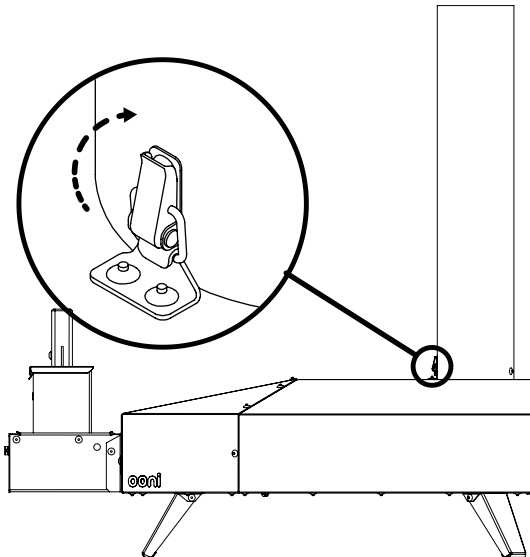

5a. Place the flame guard beneath the stone baking board and position both inside the main body.

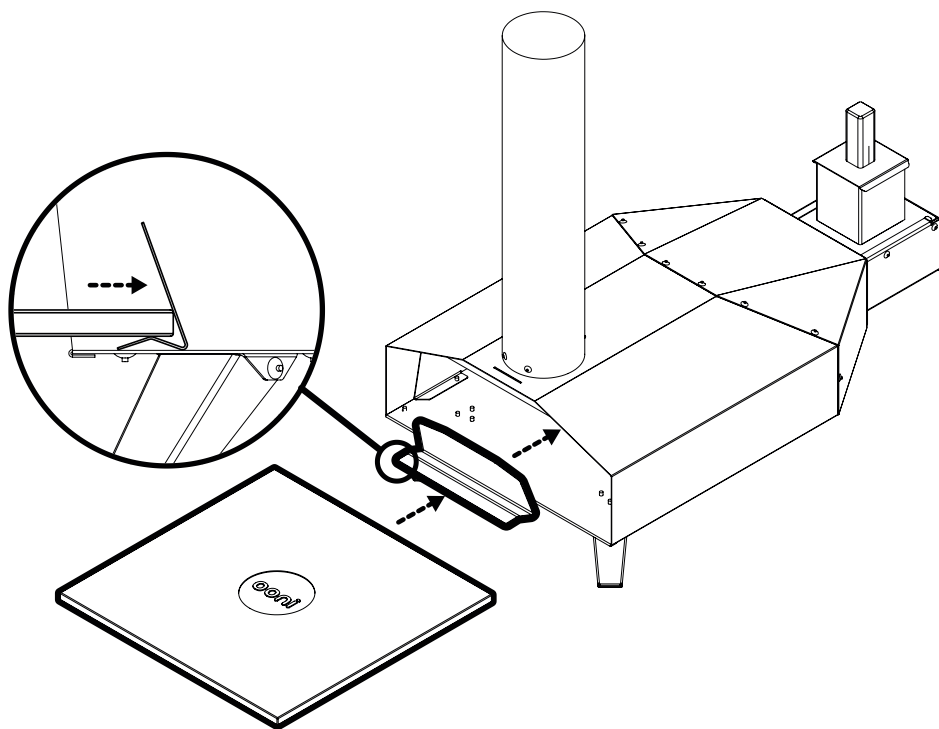

5b. Place the stone baking board close to the oven opening.

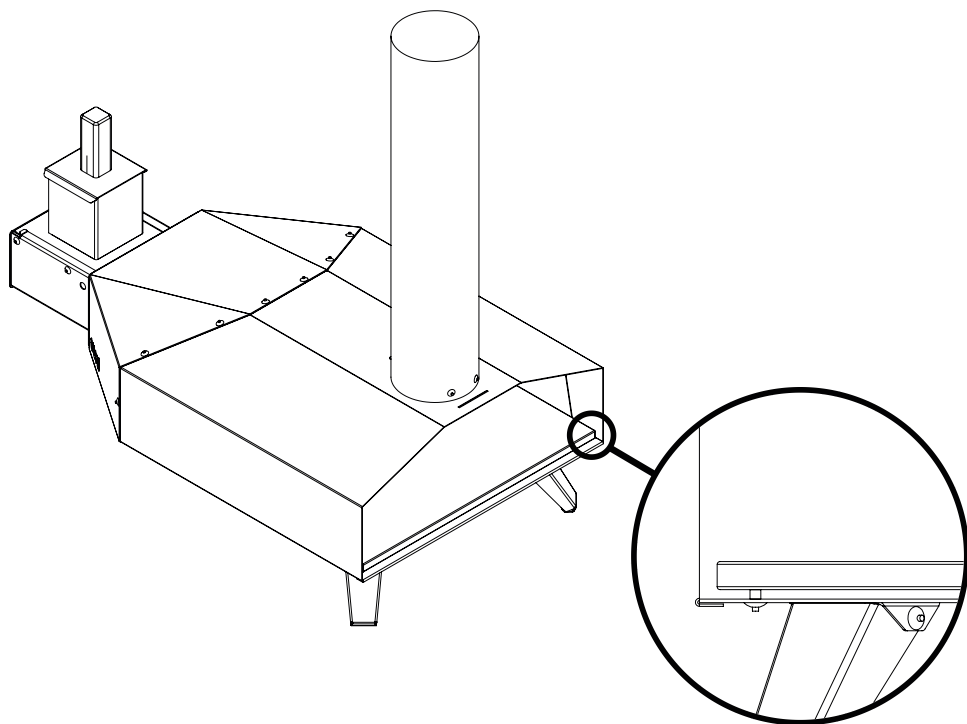

6a. Attach L-bracket to the door.

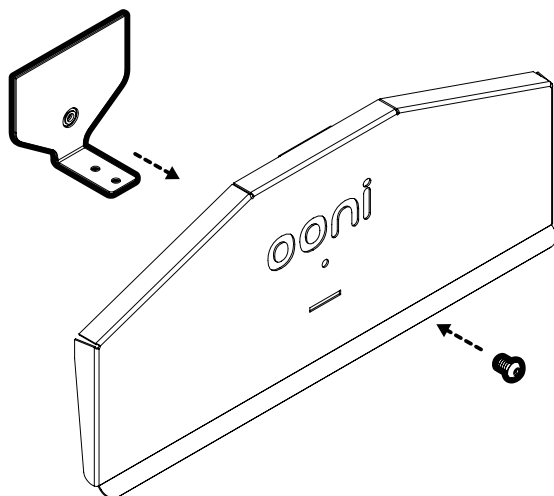

x1
M5-10mm

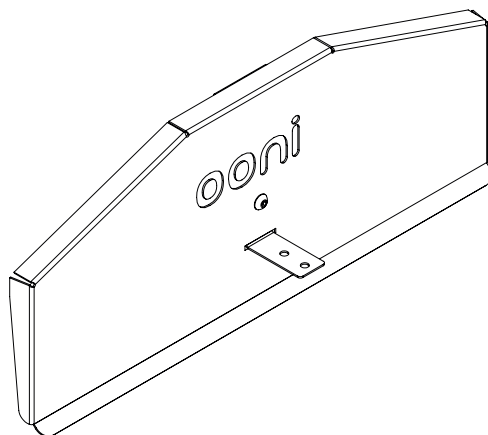

6b. Attach the door handle to the L-bracket.

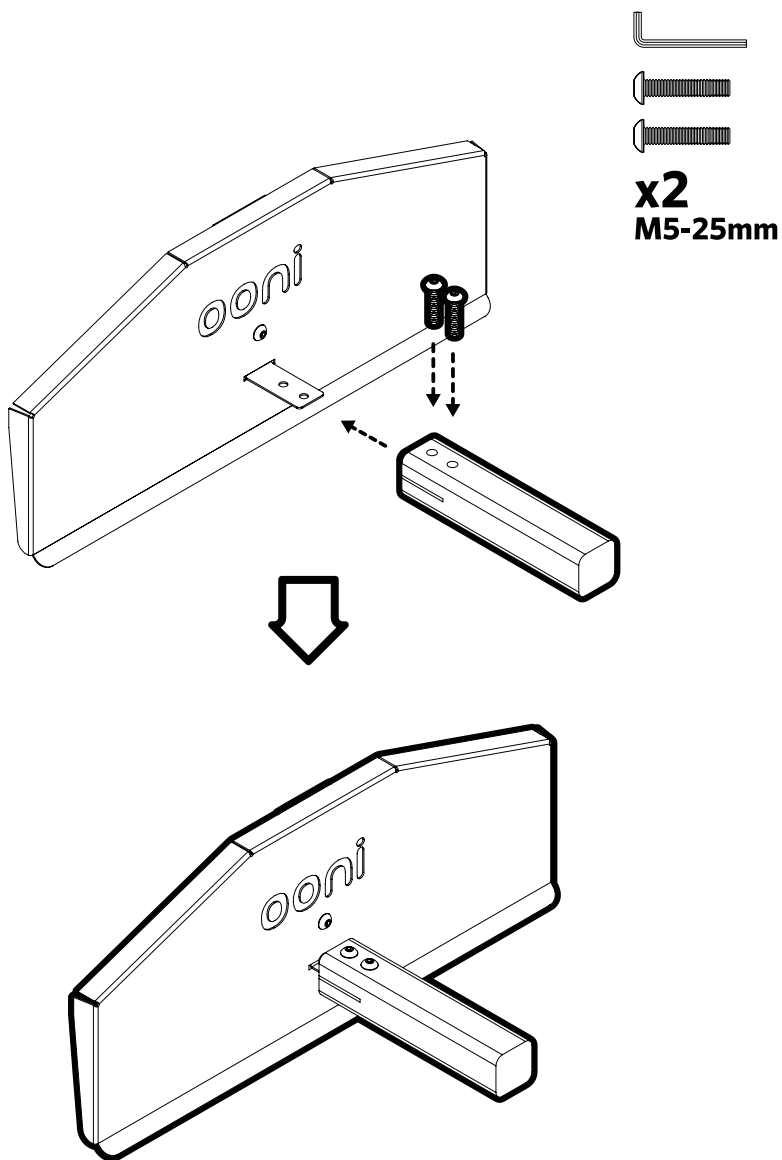

6c. Align the door tab with the slot on the main body to attach the door.

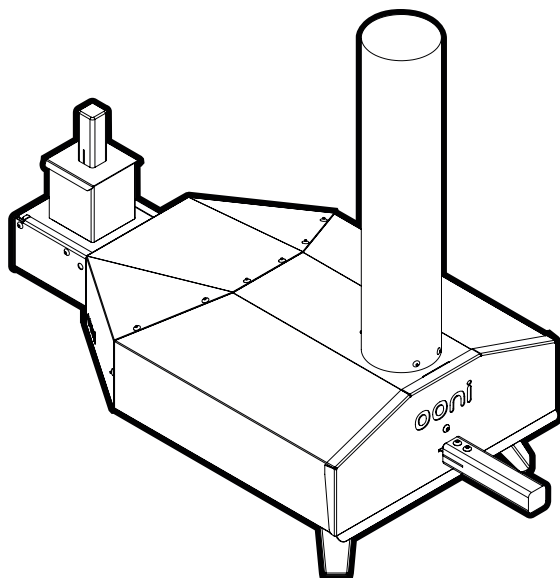
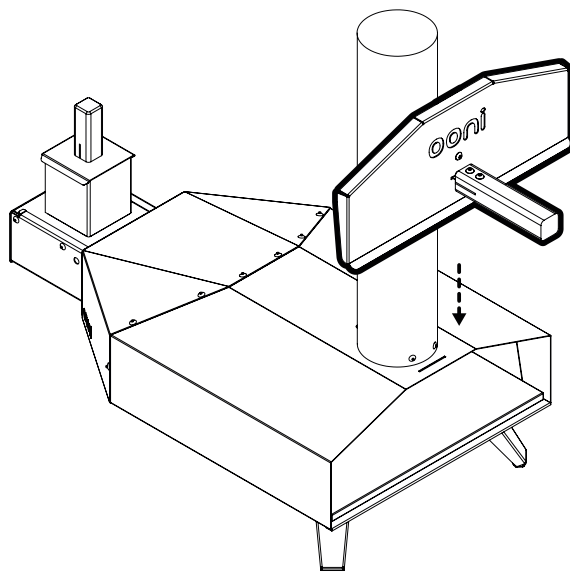

7. Insert the chimney scoop/cap when Ooni 3 is not in use.

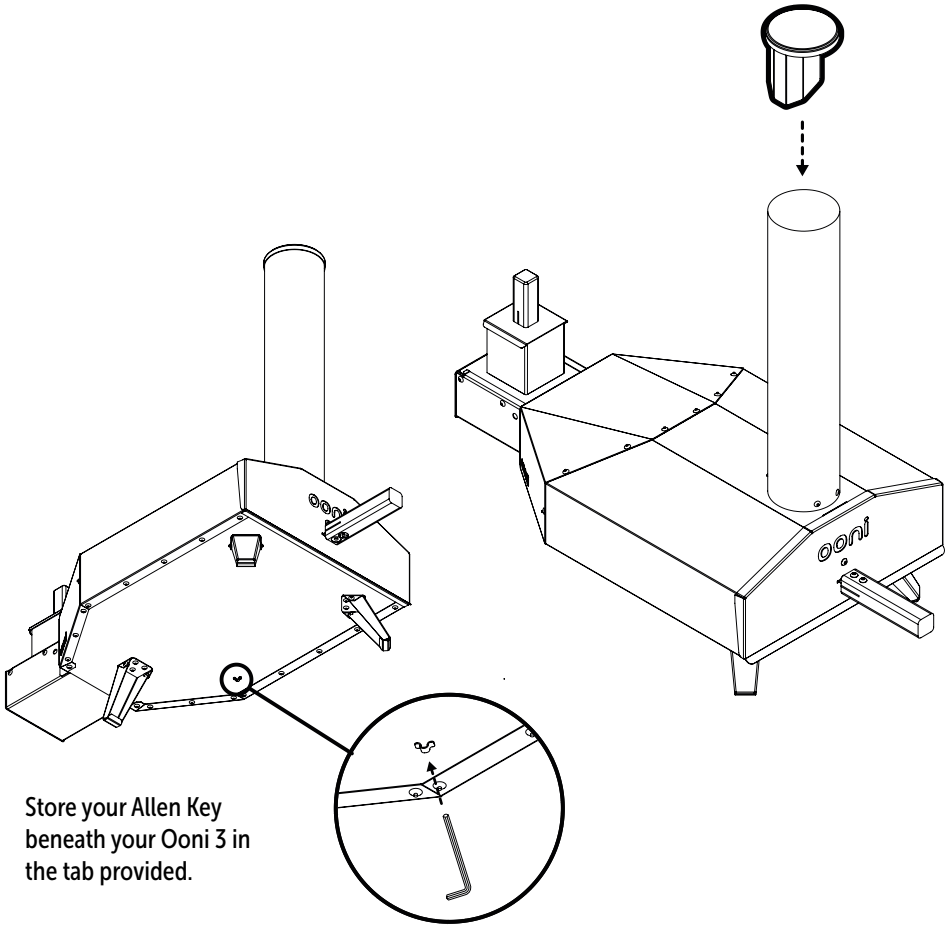

Store your Allen Key
beneath your Ooni 3 in
the tab provided.



WARNING:

This barbecue will become very hot. Do not move it during operation.

Do not use indoors.

Do not use spirit or petrol for lighting or re-lighting. Use only firelighters complying to EN 1860-3.

Keep children and pets away.

Lighting

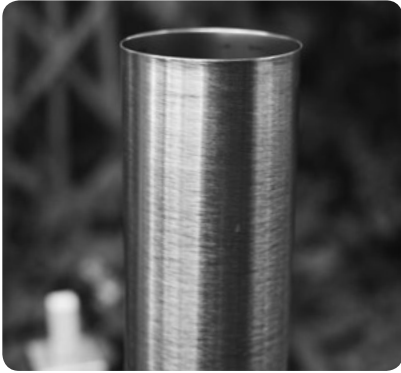

1. Remove the scoop/cap from the top of the chimney.



2. Make sure the door is on and only take it off when adding or removing food.



3. Fill the grate with 100% hardwood pellets to the level pictured above.
Approximately 400g (0.9lbs)



4a. Place a natural firestarter at the lip of the grate.



4b. Light the firestarter and slide the grate back in to the burner using the hopper lid handle. Place the hopper lid back on top of the hopper.



4c. If lighting using a blow torch, point the flame through the hole on the side of the burner. Hold it there for 30-45 seconds or until the pellets are alight.



5. Once your starter pellets are fully alight, add small amounts of pellets gradually. Allow these to light fully before topping up to the level shown in Step 6.



6. Maintain a pellet level to approximately 3cm (1") below the top of the hopper throughout the cooking session.

Extinguishing



1. Allow Ooni 3 to burn through remaining pellets and cool naturally for at least 60 minutes. While wearing heatproof gloves, carefully remove the grate using the hopper lid.



2. Shake the ash in to a large metal bucket of water. Do not submerge.



WARNING:

This barbecue will become very hot. Do not move it during operation.

Do not use indoors.

Do not use spirit or petrol for lighting or re-lighting. Use only firelighters complying to EN 1860-3.

Keep children and pets away.

ooni



ooni.com

© 2019 Ooni

Ooni is a registered trademark of Ooni Ltd.

All rights reserved.

v1.5